

ACRI 2023

in Kobe, Japan

The 1st Asian Congress for
Reproductive Immunology
(ACRI)

ACRI Kicks Off for Eternal Development

April 8 (Sat) - 9 (Sun), 2023

Venue:

Kobe International Conference Center

Honorary President:

Masahiro Itoh, M.D., Ph.D.

Professor and Chairman,
Department of Anatomy,
Tokyo Medical University

President:

Hiroaki Shibahara, M.D., Ph.D.

Professor and Chairman,
Department of Obstetrics and Gynecology,
School of Medicine, Hyogo Medical University

Program

<http://ACRI2023.umin.jp>





Clinical Laboratory
Ritz Medical Co., Ltd.

For Future
of
the Earth



リッツメディカル株式会社臨床ラボラトリーは、出生前診断関連検査に特化した臨床検査センターとして、全国の出生前診断を行なっている医療機関より検査を受託しています。

代表取締役 夫 律子

◆ 出生前診断関連染色体検査（羊水・絨毛・流産組織・末梢血）

- ・ G分染法による染色体核型判定検査
- ・ QF-PCR法による21番,13番,18番トリソミー迅速判定検査
(検体受領翌日報告)
- ・ FISH法による転座解析/モザイク解析/欠失解析
- ・ D-karyo解析® (全染色体のCNVスクリーニング検査)
(Ritz Medical独自開発項目)
- ・ SNP microarray解析
- ・ Target Exome Sequence解析 (約6,700遺伝子)
- ・ Sanger Sequence解析

◆ 妊娠初期母体血清マーカー組み合わせ検査 (OSCAR検査)

(PAPP-A, Free hCG β + NT 組み合わせ検査)
(検体受領当日報告)

◆ PGT-A解析

(日本産科婦人科学会倫理委員会・PGT-Aに関する小委員会：認定解析施設)

◆ NIPT検査

(出生前検査認証制度等運営委員会：認証分析機関)

リッツメディカル株式会社
臨床ラボラトリー

ホームページ: <http://ritz-medical.jp/>

〒543-0001

大阪市天王寺区上本町7丁目1-24 松下ビル2階

TEL: 06-6773-5511 / FAX: 06-6773-5510

【お問い合わせ】

E-Mail: ritz-info@ritz-med.com

Contents

Welcome Message	2
Committees	3
Venue Map	5
Congress Information	7
Outstanding Award	10
Program at a Glance	12
Program	15
Sponsors	27



ACRI 2023 in Kobe, Japan

Welcome Message



Dear Colleagues and Friends,

I am delighted to announce that the 1st Asian Congress for Reproductive Immunology (ACRI) will take place from 8th (Sat) to 9th (Sun), April, 2023 at International Conference Center Kobe, in Kobe city, Hyogo prefecture, Japan.

ACRI was established mainly in Japan, Korea, and China, and we plan to strengthen cooperation with Asian countries where research on reproductive immunology is active in the near future. Furthermore, we hope that the organization will grow to be on a par with the American Society for Reproductive Immunology and the European Society for Reproductive Immunology, and deepen exchanges between the two societies.

We will have many experts from Asian countries for symposiums and lectures in the 1st ACRI. It is for sure that this congress will be the most interesting opportunity to learn latest reproductive immunology researches.

I warmly welcome you all in this exciting ACRI in Kobe city.

Sincerely,

Handwritten signature of Hiroaki Shibahara in black ink.

Hiroaki Shibahara, MD, PhD

President

The 1st Asian Congress for Reproductive Immunology (ACRI)

Professor and Chairman

Department of Obstetrics and Gynecology

School of Medicine, Hyogo Medical University

Committees

*In alphabetical order, by last name

Honorary President

Masahiro Itoh (Department of Anatomy, Tokyo Medical University)

President

Hiroaki Shibahara (Department of Obstetrics and Gynecology, School of Medicine, Hyogo Medical University)

Secretary-General

Atsushi Fukui (Department of Obstetrics and Gynecology, School of Medicine, Hyogo Medical University)

International Organizing Committee

Lianghui Diao (Shenzhen Key Laboratory of Reproductive Immunology for Peri-implantation, Shenzhen Zhongshan Institute for Reproduction and Genetics, Fertility Center, Shenzhen Zhongshan Urology Hospital, Shenzhen, China)

Meirong Du (Obstetrics and Gynecology Hospital, Fudan University, Shanghai, China)

Sung Ki Lee (Department of Obstetrics and Gynecology, Konyang University, South Korea)

Aihua Liao (Institute of Reproductive Health, Center for Reproductive Medicine, Tongji Medical College, Huazhong University of Science and Technology, Wuhan, China)

Ji Eun Oh (Graduate School of Medical Science and Engineering, KAIST, South Korea)

Joon-Cheol Park (Dept. of Obstetrics and Gynecology, School of Medicine, Kyungpook University, South Korea)

Chong Qiao (Department of Obstetrics and Gynecology, Shengjing Hospital, China Medical University, Shenyang, China)

Shigeru Saito (University of Toyama, Japan)

Haengseok Song (Department of Biomedical Science, Cha University, South Korea)
Toshiyuki Takeshita (Takeshita Ladies Clinic, Japan)
Tatsuo Yamamoto (Kasukabe Medical Center, Japan)

Local Organizing Committee

Tomoyuki Fujii (Gynecological Oncology & Gynecology, Sanno Hospital)
Satoshi Hayakawa (Division of Microbiology, Department of Pathology and Microbiology, Nihon University School of Medicine)
Masahito Ikawa (Research Institute for Microbial Diseases, Osaka University)
Kei Kawana (Department of Obstetrics and Gynecology, Nihon University School of Medicine)
Nagamasa Maeda (Department of Obstetrics and Gynecology, Medical School, Kochi University)
Akitoshi Nakashima (Department of Obstetrics and Gynecology, University of Toyama)
Toshihiro Takizawa (Department of Molecular Medicine and Anatomy, Physiology, Nippon Medical School)
Hideto Yamada (Center for Recurrent Pregnancy Loss, Teine Keijinkai Hospital)

Congress Secretariat

c/o Convex Inc.

BPR Place Kamiyacho, 1-11-9 Azabudai, Minato-ku, Tokyo 106-0041 Japan

Tel: +81-3- 3505-1600 Fax: +81-3- 3505-3366

E-mail: acri2023@convex.co.jp

Venue Map

Kobe International Conference Center, 3rd Floor

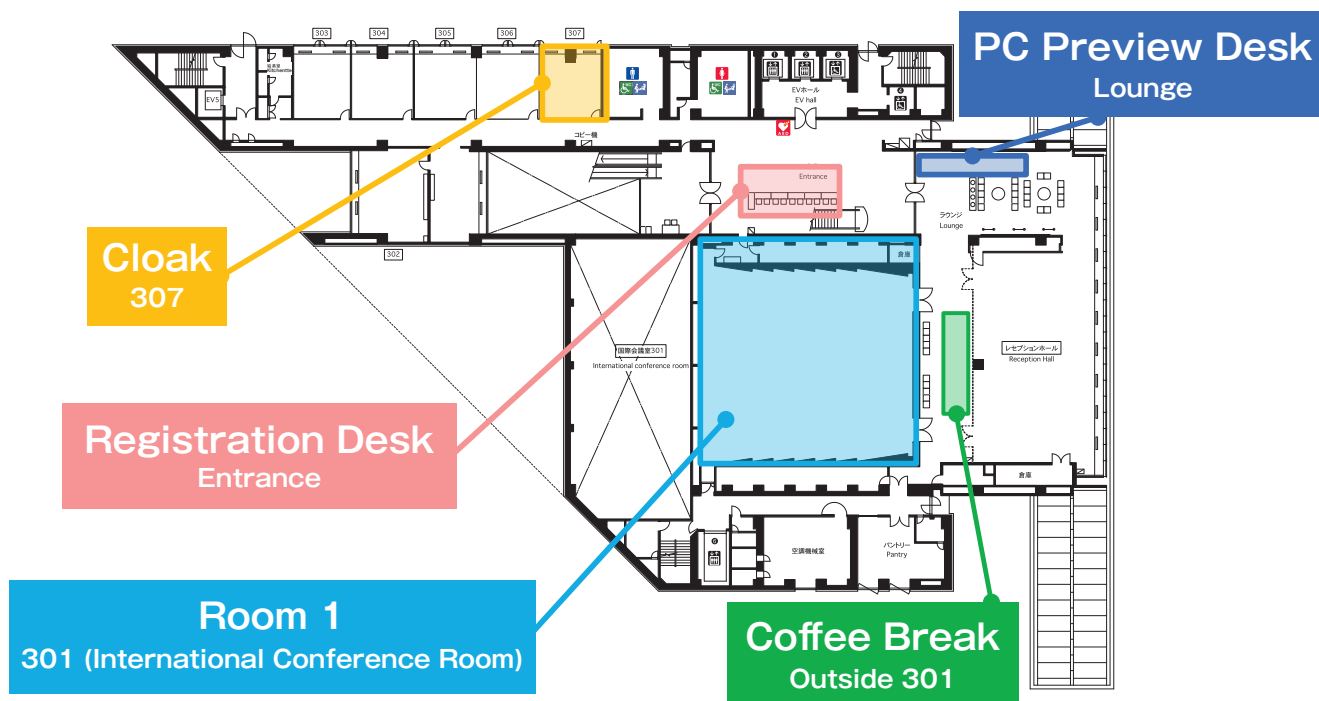

Kobe International Conference Center, 4th Floor

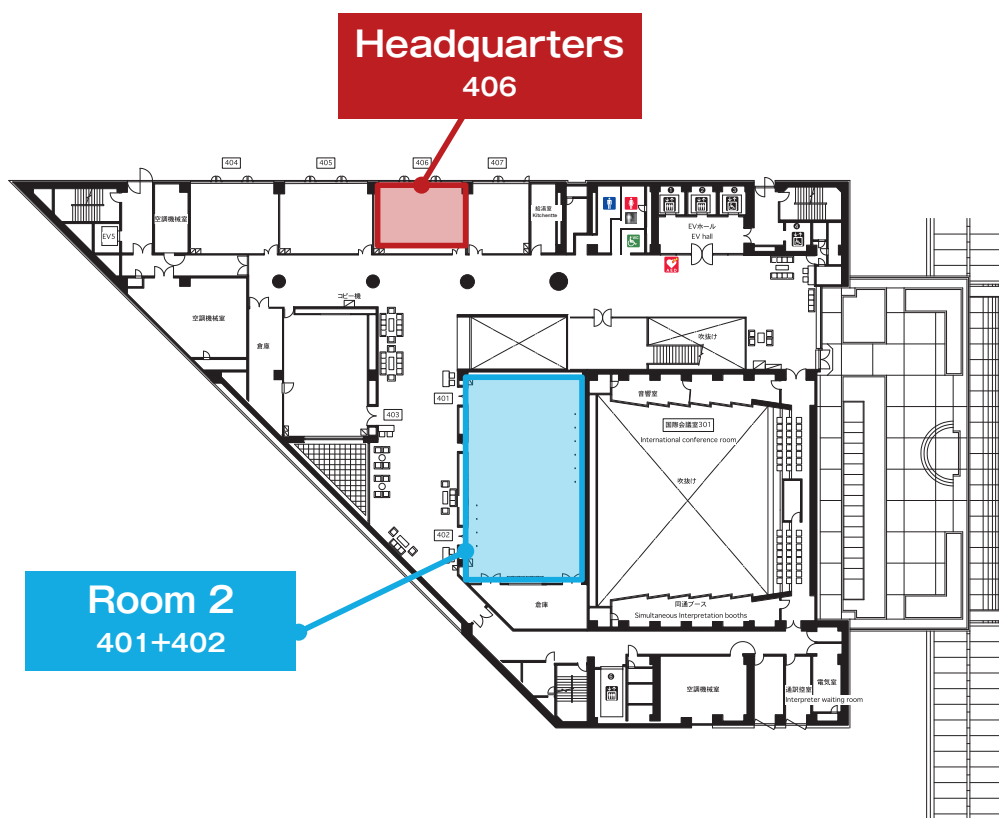

Venue Map

Banquet Hall Kairaku, B1 Floor, Main Building, Kobe Portopia Hotel

B1

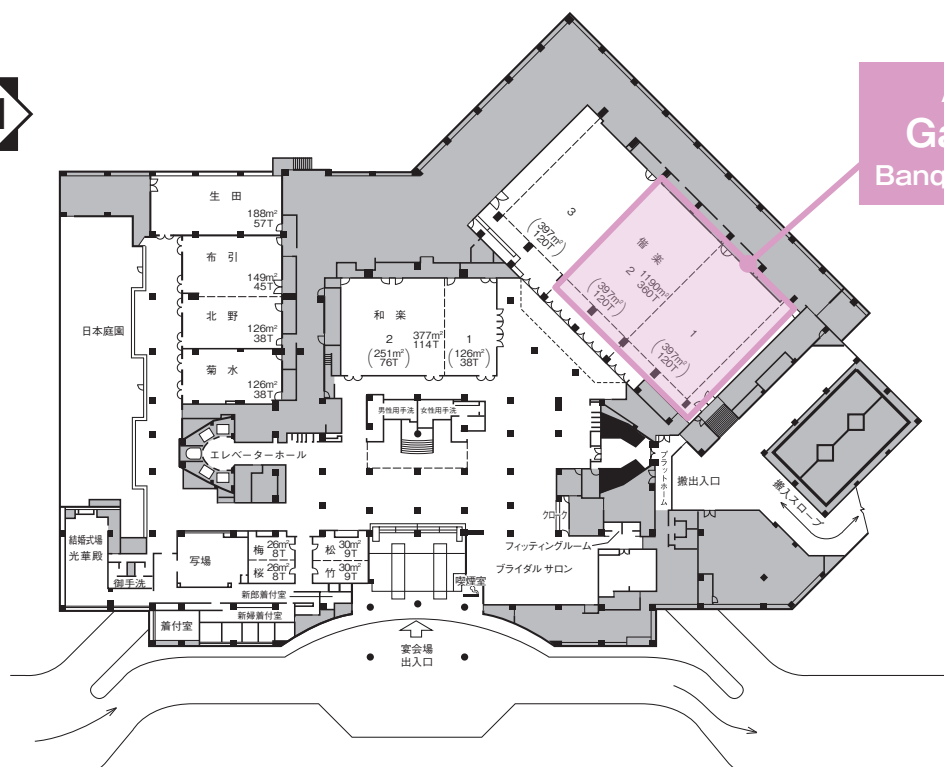

April 8 (Sat)
Gala Dinner
Banquet Hall Kairaku

*Kobe International Conference Center and Main Building of Kobe Portopia Hotel are connected by a passage on the 2nd floor.

Congress Information

Registration Desk

The Registration Desk is located at the entrance of the 3rd Floor and is open during the following hours:

April 8 (Sat) 10:50-17:00
 April 9 (Sun) 08:00-15:00

Registration Fee (For On-site)

Category	Price
Delegate	JPY 50,000
Student	JPY 25,000
Accompanying Person (family member)	JPY 10,000

*Gala Dinner is included in the registration fee; however, priority is given to those who pre-registered for the event.

Payment Method

Payment must be made by credit card.

Accepted credit cards are VISA, MasterCard, Diners Club, AMEX, and JCB.



Name Badge, Certificate and Program Book

You are requested to come to the Registration Desk to pick up your congress kit within the above time frame. The name badge is mandatory for access to all sessions and social events during the congress.

Cloak Room

Cloak Room is located at 307 on the 3rd Floor and is open during the following hours:

April 8 (Sat) 10:50-18:00
 April 9 (Sun) 08:00-16:30

Internet Access

Free WiFi is available on the 3rd and 4th floors in the Kobe International Conference Center. WiFi details will be announced onsite.

Coffee Break

Provided outside Room 1 (301) during the following hours:

April 8 (Sat) 14:35-14:50
 April 9 (Sun) 10:25-10:40 / 14:15-14:30

Luncheon Seminar

Lunch boxes will be available at Room 1 (301) during the following hours:

April 8 (Sat) 12:10-13:10 Luncheon Seminar 1
 April 9 (Sun) 11:50-12:50 Luncheon Seminar 2

Social Event

- Gala Dinner

Date: Saturday, April 8

Time: 18:00-20:00

Place: Banquet Hall Kairaku, B1 Floor, Kobe Portopia Hotel

Fee: Included in the registration fee

*Priority is given to those who pre-registered for the event.

Safety and Security

Please do not leave valuable things unattended at any time, whether inside or outside session.

Congress Etiquette

- Participants are advised not to photograph or video and voice record any sessions without the author's consent. Participants are also advised to obtain consent from authors before citing any of their work presented at the congress.
- Switch your mobile phone to silent mode or turn it off completely during the sessions. Turn off the volume of other electronic devices such as, PC and DVD, and reduce screen brightness. We appreciate your cooperation.

Prevention Measures against COVID-19

1. If you have a fever or COVID-like symptoms, Please inform the staff at the Registration Desk, You may request to purchase an antigen test kit for self-testing.
2. Wear your facemask.
3. Hand sanitizers are placed around the congress venue. Clean and disinfect your hands thoroughly.
4. Follow the rules and regulations of the facility.

Instructions for Chairs

1. Please come to your session room 15 minutes before your session starts. The seat for next chair will be in the front row on the right.
2. Please proceed with the session per the following time allocation.

Instructions for Presentation

I. Oral Presentation

1. The time allotted for each presentation is scheduled as follows:
 - Opening Lecture30 min incl. Q&A
 - Special Lecture 1, 3, 4, 660 min incl. Q&A
 - Special Lecture 2, 540 min incl. Q&A
 - Symposium 1, 2, 320 min + 5 min Q&A
 - Educational Seminar30 min incl. Q&A
 - Luncheon Seminar 1, 230 min incl. Q&A
 - Outstanding Award 1, 28 min + 4 min Q&A
 - Oral 1, 2, 3, 4, 5, 6, 7, 8, 9, 108 min + 4 min Q&A
2. All presentations will be done on PC.
3. PCs with Windows 10 and PowerPoint 2013, 2016 are to be used onsite.
Macintosh users: Please bring your own computer for your presentation.
4. Please bring your own PC or presentation data (PPT) saved in a storage device. Acceptable storage devices are CD-R and USB Flash memory only.

5. Audio, video and animation are playable on the PCs used onsite. If you are bringing your presentation data in storage devices, please make sure that the data is compatible with Media Players for Windows.
6. Standard PC fonts for Windows should be used. Recommended slide size is 16:9.
7. If you are using your own PC, please make sure to bring an AC adaptor (standard 2-pin type) to charge your PC. For projector output purposes, a VGA cable or HDMI cable will be provided. Please confirm whether your PC is equipped with a VGA port (mini D-sub 15 pin type) or HDMI port. If you use a different type of port to connect to an external monitor, please bring a converter with you. Please turn off your screen saver and power saving settings in advance, especially if your presentation includes video and sound.

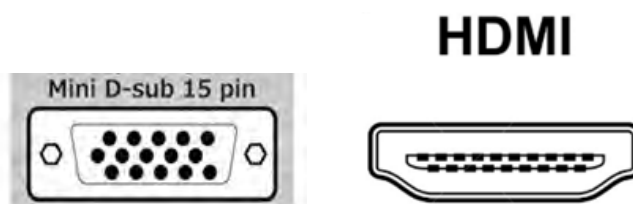

8. Please bring your PC or presentation data to the PC Preview Desk at least 30 minutes prior to your presentation to register and submit it for testing the connection and viewing your file.
9. The PC Preview Desk will be located at the lounge area of 3rd floor and will open during the following hours:

April 8 (Sat)	10:50-16:30
April 9 (Sun)	08:00-14:30
10. Please use the mouse on the podium for your presentation. You are required to handle your data yourself by using the mouse.
11. The copied data of your presentation will be deleted by the secretariat after the congress.

II. Disclosure of Conflicts of Interest (COI)

Example of declaration in slides

All presenters must declare their COI status on the first presentation slide (or immediately after the title and presenters) as below.

e.g. 1)

ACRI 2023
COI Declaration
 Affiliation Name (all presenters)
 The presenter has no conflict of interest with any corporate organizations relating to this presentation.

e.g. 2)

ACRI 2023
COI Declaration
 Affiliation Name (all presenters)
 The presenter has conflicts of interest with the corporate organizations below:
 Name of organizations

Outstanding Award

Seven outstanding abstracts have been selected by the organizing committee for receiving the Outstanding Award. All presentations will be carried out during Outstanding Award 1 & 2 of the program. Each presenter will receive a prize of JPY 30,000 in cash during the Award Ceremony on Sunday, April 9.

*For Japanese participants

専門医単位について

ACRI 2023に参加された方は、下記のとおり単位取得が可能です。

1. 日本産科婦人科学会専門医研修出席証明（10点）および日本専門医機構学術集会参加単位（3単位）
 - ・当日受付にて 「JSOGカード/JSOGアプリ会員証」による出席証明を行いますので、会員の皆様は「JSOGカード/JSOGアプリ会員証」をご持参ください。
 - ・JSOGカード/JSOGアプリ会員証をご持参の会員の方
JSOGカード/JSOGアプリ会員証にて参加登録いただいた方は、専門医研修出席証明が電子的に登録されます。
 - ・JSOGカード/JSOGアプリ会員証を未受取・お忘れ等でお持ちでない会員の方
参加登録時に、JSOGカード/JSOGアプリ会員証をお持ちでない方は当日受付にご用意いたします芳名帳にご記名をお願いいたします。事務局で代理登録させていただきます。
2. 日本専門医機構単位付与講習
以下のセッションで講習受講証明を行います。1と同様、「JSOGカード/JSOGアプリ会員証」による（当日お持ちでない方は芳名帳への記名による）講習受講証明を行います。
 - ・ Special Lecture 1、3、4、6 - 日本専門医機構、産婦人科領域講習 / 各1ポイント
 - ・ Luncheon Seminar 1、2 - 日本専門医機構、産婦人科領域講習 / 各1ポイント

Contact

Congress Secretariat

c/o Convex Inc.

BPR Place Kamiyacho, 1-11-9 Azabudai, Minato-ku, Tokyo 106-0041 Japan

Tel: +81-3- 3505-1600 Fax: +81-3- 3505-3366

E-mail: acri2023@convex.co.jp

Program at a Glance

Day 1, Saturday, April 8	
Room 1	Room 2
International Conference Room (301)	401+402
8:00	
9:00	
10:00	
11:00	
11:25-11:30	
Opening Remarks Hiroaki Shibahara (Hyogo Medical University)	
11:30-12:00	
Opening Lecture Chair: Tadashi Kimura (Osaka University) Speaker: Shigeru Saito (University of Toyama)	
12:00	
12:10-13:10	
Luncheon Seminar 1 P Chair: Mikiya Nakatsuka (Okayama University) Speakers: Takeshi Iwasa (Tokushima University) Tetsunori Mukaida (Hiroshima Hart Clinic) Co-sponsored by: Setouchi Society for Assisted Reproductive Technology	
13:00	
13:15-14:35	
Symposium 1 Endometriosis Chairs: Takashi Murakami (Shiga University of Medical Science) Kaori Koga (Chiba University) Speakers: Kaori Koga (Chiba University) Ayano Yamaya (Hyogo Medical University) Ae Ra Han (CHA University)	13:30-14:06
14:00	Oral 1: Recurrent Pregnancy Loss-1 Chair: Masashi Deguchi (Kobe University)
14:35-14:50	14:06-15:06
Coffee Break	Oral 2: Recurrent Pregnancy Loss-2 Chair: Atsushi Fukui (Hyogo Medical University)
14:50-15:50	15:06-15:54
Special Lecture 1 P Chair: Hideto Yamada (Teine Keijinkai Hospital) Speaker: Sung Ki Lee (Konyang University)	Oral 3: Endometrium and Embryo Chair: Koji Nakagawa (Sugiyama Clinic)
15:00	15:54-16:42
15:55-16:35	Oral 4: Repeated Implantation Failure Chair: Fuminori Kimura (Nara Medical University)
Special Lecture 2 Chair: Tomohiko Wakayama (Kumamoto University) Speaker: Masahito Ikawa (Osaka University)	16:42-17:30
16:40-17:40	Oral 5: Preeclampsia and Placenta Chair: Akihide Ohkuchi (Jichi Medical University)
17:00	
Special Lecture 3 P Chair: Tomoyuki Fujii (Sanno Hospital) Speaker: Satoshi Hayakawa (Nihon University)	
18:00	
18:00-20:00	
Gala Dinner Banquet Hall Kairaku, B1F, Main Building Kobe Portopia Hotel	

*For Japanese participants: **P** マークのセッションは日本専門医機構産婦人科領域講習として承認されています。

Program at a Glance

Day 2, Sunday, April 9	
Room 1	Room 2
International Conference Room (301)	401+402
8:00	
8:30-9:50	8:30-9:06
Symposium 2 Recurrent Pregnancy Loss Chairs: Yasuhiko Ozaki (Nagoya City University) Yasuyuki Negishi (Nippon Medical School) Speakers: Kenji Tanimura (Kobe University) Yanhong Li (Fudan University) Jaewon Han (Konyang University Hospital)	Outstanding Award 1 Chair: Mayumi Sugiura (Nagoya City University)
9:00	9:06-9:54
	Outstanding Award 2 Chair: Hidetaka Okada (Kansai Medical University)
10:00	9:56-10:11
9:55-10:25 Educational Seminar Chair: Hideaki Sawai (Hyogo Medical University) Speaker: Ritsuko Kimata Poo (CRIFM Prenatal Medical Clinic) Co-sponsored by: GE Healthcare/Nanosonics/YAYOI	Award Ceremony
10:25-10:40	10:13-11:13
Coffee Break	Oral 6: Endometriosis and Gynecological Cancer Chair: Kei Kawana (Nihon University)
10:40-11:40	11:13-11:37
Special Lecture 4 P Chair: Akitoshi Nakashima (University of Toyama) Speaker: Meirong Du (Fudan University) [Video]	Oral 7: COVID-19 Chair: Hiroyuki Tanaka (Hyogo Medical University)
12:00	
11:50-12:50	
Luncheon Seminar 2 P Chair: Yoshiharu Morimoto (HORAC Grand Front Osaka Clinic) Speakers: Masahide Shiotani (Hanabusa Women's Clinic) Atsushi Fukui (Hyogo Medical University) Co-sponsored by: Japan Society of Assisted Reproduction	
13:00	13:00-13:48
12:55-14:15	Oral 8: Sperm, Testis and Male Infertility-1 Chair: Akiko Hasegawa (Hyogo Medical University)
Symposium 3 Premature Labor/ Preeclampsia Chairs: Takeshi Nagamatsu (International University of Health and Welfare) Katsuhiko Naruse (Dokkyo Medical University) Speakers: Hironori Takahashi (Jichi Medical University) Jinying Yang (Longgang District Maternal & Child Healthcare Hospital) Yong-Sun Maeng (Yonsei University College of Medicine)	13:48-14:24
14:00	Oral 9: Sperm, Testis and Male Infertility-2 Chair: Masakatsu Fujinoki (Dokkyo Medical University)
14:15-14:30	14:24-15:00
Coffee Break	Oral 10: Preterm Birth Chair: Koichiro Shimoya (Kawasaki Medical School)
14:30-15:10	
Special Lecture 5 Chair: Toshiyuki Takeshita (Takeshita Ladies Clinic) Speaker: Toshihiro Takizawa (Nippon Medical University)	
15:00	
15:10-16:10	
Special Lecture 6 P Chair: Hiroaki Shibahara (Hyogo Medical University) Speaker: Joanne Y.H. Kwak-Kim (Rosalind Franklin University of Medicine and Science) [Video]	
16:00	
17:00	
16:10-16:15	
Closing Remarks	
18:00	

*For Japanese participants: **P** マークのセッションは日本専門医機構産婦人科領域講習として承認されています。

Program

Day 1, Saturday, April 8

Room 1

11:25 - 11:30

Opening Remarks

ACRI 2023 President : Hiroaki Shibahara

Department of Obstetrics and Gynecology, School of Medicine, Hyogo Medical University

11:30 - 12:00

Opening Lecture

Chair : Tadashi Kimura

Obstetrics and Gynecology, Department of Organ Regulation Medicine, Graduate School of Medicine, Faculty of Medicine, Osaka University

OL

Decreased paternal/fetal antigen-specific Treg cells are involved in the pathogenesis of preeclampsia, and decreased Treg cells pool are involved in the pathogenesis of miscarriage

Shigeru Saito

University of Toyama

12:10 - 13:10

Luncheon Seminar 1 : PGT-A

Sponsored by: [Setouchi Society for Assisted Reproductive Technology](#)

Chair : Mikiya Nakatsuka

Graduate School of Health Sciences, Okayama University

LS1-1

PGT-A, past, present, and future in Japan

Takeshi Iwasa

Department of Obstetrics and Gynecology, Tokushima University Graduate School of Biomedical Sciences

LS1-2

Our strategy to maximize clinical PGT program

Tetsunori Mukaida

Hiroshima HART Clinic

13:15 - 14:35

Symposium 1 : Endometriosis

Chairs : Takashi Murakami

Department of Obstetrics and Gynecology, Shiga University of Medical Science

Kaori Koga

Department of Obstetrics and Gynecology, Graduate School of Medicine Chiba University

S1-1

The peritoneal immune environment in the pathogenesis of endometriosis

Kaori Koga

Department of Obstetrics and Gynecology, Graduate School of Medicine Chiba University

S1-2

NK cell abnormalities and endometriosis

Ayano Yamaya

Department of Obstetrics and Gynecology, School of Medicine, Hyogo Medical University

S1-3 Infection and Inflammation in the Pathogenesis of Endometriosis

Ae Ra Han
CHA University Fertility Center Daegu

14:35 - 14:50 Coffee Break: Outside Room 1 (301)

14:50 - 15:50 Special Lecture 1

Chair : Hideto Yamada
Center for Recurrent Pregnancy Loss, Teine Keijinkai Hospital

SL1 Immunotherapy for reproductive failure women in Korea: present and future

Sung Ki Lee
Department of Obstetrics and Gynecology, Konyang University College of Medicine

15:55 - 16:35 Special Lecture 2

Chair : Tomohiko Wakayama
Department of Histology, Faculty of Life Sciences, Kumamoto University

SL2 Testis-enriched genes and their functions for spermatogenesis and fertilization

Masahito Ikawa
Department of Experimental Genome Research, Genome Information Research Center, Research Institute for Microbial Diseases, Osaka University

16:40 - 17:40 Special Lecture 3

Chair : Tomoyuki Fujii
Sanno Hospital

SL3 Placental-microbial interactions; Possible roles of endometrial commensals in trophoblast invasion and placental barrier against pathogenic viruses

Satoshi Hayakawa
Division of Microbiology Department of Pathology and Microbiology, Nihon University School of Medicine

13:30 - 14:06

Oral 1 : Recurrent Pregnancy Loss-1

Chair : Masashi Deguchi

Department of Obstetrics and Gynecology, Kobe University Graduate School of Medicine

O1-1

Clinical efficacy of low-molecular-weight heparin plus aspirin versus aspirin alone in repeat pregnancy loss women with thrombotic causes

Joon Cheol Park

Department of Obstetrics and Gynecology, School of Medicine, Kyungpook National University

O1-2

A case of severe fetal growth restriction with oligohydramnios was successfully treated with antithrombotic therapy

Tomoko Ichikawa

Department of Obstetrics and Gynecology, Nippon Medical School

O1-3

AREG⁺ NK cell accelerates decidualization by interacting with IGF1⁺ stromal cell

Jia-Wei Shi

NHC Key Lab of Reproduction Regulation, Hospital of Obstetrics and Gynecology, Shanghai Institute for Biomedical and Pharmaceutical Technologies, Fudan University

14:06 - 15:06

Oral 2 : Recurrent Pregnancy Loss-2

Chair : Atsushi Fukui

Department of Obstetrics and Gynecology, School of Medicine, Hyogo Medical University

O2-1

Dysfunction of CCR1⁺ Decidual Macrophages is a Potential Risk Factor in the Occurrence of Unexplained Recurrent Pregnancy Loss

Yifei Sang

Hospital of Obstetrics & Gynecology, Fudan University

O2-2

Role of PROK1 in decidua of patients with unexplained recurrent pregnancy loss showing insulin hypersecretion

Shinobu Goto

Department of Obstetrics and Gynecology, Nagoya City University Graduate School of Medical Science

O2-3

Obesity Challenge Drives Distinct Maternal Immune Response Changes in Normal Pregnant and Abortion Prone Mouse Models

Yanhong Li

Hospital of Obstetrics & Gynecology, Fudan University

O2-4

LPA promotes the autophagy of trophoblast cells in early pregnancy

Jun Shao

Hospital of Obstetrics & Gynecology, Fudan University

O2-5

Expression of cell adhesion molecules on peripheral blood NK cells in recurrent pregnancy losses

Ayano Yamaya

Department of Obstetrics and Gynecology, School of Medicine, Hyogo Medical University

15:06 - 15:54

Oral 3 : Endometrium and Embryo

Chair : Koji Nakagawa
Sugiyama Clinic Shinjuku

O3-1 Risk factors for chronic endometritis in infertile women with intrauterine disorders after hysteroscopic surgery

Keiji Kuroda
Sugiyama Clinic Shinjuku, Center for Reproductive Medicine and Endoscopy

O3-2 Abnormalities in the endometrial microbiota may affect pregnancy outcomes of assisted reproductive technology.

Motowo Nabeta
Tsubaki Women's Clinic

O3-3 Bioinformatics Analysis Identifies Potential Biomarkers and Immune Infiltration Characteristics in Recurrent Implantation Failure

Zhen-zhen Lai
NHC Key Lab of Reproduction Regulation, Hospital of Obstetrics and Gynecology, Shanghai Institute for Biomedical and Pharmaceutical Technologies, Fudan University

O3-4 Effects of conditioned media from polarized macrophages on mouse pre-implantation embryonic development and outgrowth of blastocysts

Jin Hyun Jun
Department of Biomedical Laboratory Science, Graduate School, Eulji University

15:54 - 16:42

Oral 4 : Repeated Implantation Failure

Chair : Fuminori Kimura
Department of Obstetrics and Gynecology, Nara Medical University

O4-1 Evaluation of the tacrolimus treatment using euploid blastocyst for women with repeated implantation failures showing elevated type-1 helper T (Th1)/Th2 cell ratios

Koji Nakagawa
Sugiyama Clinic Shinjuku

O4-2 The distribution of serum Th1/2 ratio and NK cell activity in patients with recurrent implantation failure

Yih sien Enatsu
Hanabusa Women's Clinic

O4-3 Evidence for Correlation between Novel Autoantibody against Phospholipid Named Neoself Antibody (β 2GPI/HLA-DR) and Complement Consumption in Infertile Patients

Hirota Matsumi
Matsumi Ladies Clinic Mita

O4-4 Does intrauterine infusion of PRP affect the window of implantation?

Kunihiro Enatsu
Hanabusa Women's Clinic Nishinomiya

16:42 - 17:30

Oral 5 : Preeclampsia and Placenta

Chair : Akihide Ohkuchi

Department of Obstetrics and Gynecology, Jichi Medical University

O5-1

Development of an in vitro preeclampsia model in the villous tissue using an autophagy inhibitor, Bafilomycin

Atsushi Furuta

Department of Obstetrics and Gynecology, University of Toyama

O5-2

The advanced possibility of pravastatin in advanced maternal aged pregnancy complicated preeclampsia

Risa Miyatake

Obstetrics and Gynecology, Faculty of Medicine, the University of Tokyo

O5-3

IL-18 induces proper inflammation contributing placental development and fetal growth

Hajime Ino

Department of Obstetrics and Gynecology, Nippon Medical School

O5-4

Trophoblast cell line BeWo cell-derived nanoparticles contain a large amount of placenta-specific microRNAs and modify the gene expression of recipient immune cells (T lymphocyte cell line Jurkat cells)

Syunya Noguchi

Department of Molecular Medicine and Anatomy, Nippon Medical School

18:00 - 20:00

Gala Dinner : Banquet Hall Kairaku, B1F, Main Building, Kobe Portopia Hotel

8:30 - 9:50

Symposium 2 : Recurrent Pregnancy Loss (RPL)

Chairs : Yasuhiko Ozaki

Clinical Department of Obstetrics and Gynecology, Nagoya City University West Medical Center

Yasuyuki Negishi

Department of Microbiology and Immunology, Nippon Medical School

S2-1

Autoantibodies against $\beta 2$ -glycoprotein I/HLA class II complexes is associated with recurrent pregnancy loss

Kenji Tanimura

Department of Obstetrics and Gynecology, Kobe University Graduate School of Medicine

S2-2

Decidual CXCR4⁺ CD56^{bright} NK cells as a novel NK subset in maternal-fetal immune tolerance to alleviate early pregnancy failure

Yanhong Li

Hospital of Obstetrics & Gynecology, Fudan University

S2-3

Pregnancy Outcome of Intravenous Immunoglobulin in women with Recurrent Pregnancy Loss

Jaewon Han

Department of Obstetrics and Gynecology, College of Medicine, Konyang University

9:55 - 10:25

Educational SeminarSponsored by: GE Healthcare Japan Corporation
Nanosonics Japan K. k.
YAYOI Corporation

Chair : Hideaki Sawai

Department of Obstetrics and Gynecology, School of Medicine, Hyogo Medical University

ES

Brain Asymmetry associated with Genetics

Ritsuko Kimata Pooh

Fetal Diagnostic Center, Fetal Brain Center, CRIFM Prenatal Medical Clinic

10:25 - 10:40

Coffee Break: Outside Room 1 (301)

10:40 - 11:40

Special Lecture 4

Chair : Akitoshi Nakashima

Department of Obstetrics & Gynecology, University of Toyama

SL4

NK Cell and Pregnancy Immune Tolerance

Meirong Du [Video]

Obstetrics and Gynecology Hospital, Fudan University

11:50 - 12:50

Luncheon Seminar 2 : Repeated Implantation Failure

Sponsored by: Japan Society of Assisted Reproduction

Chair : Yoshiharu Morimoto
HORAC Grand Front Osaka Clinic

LS2-1 Clinical approach to recurrent implantation failure

Masahide Shiotani
Hanabusa Women's Clinic

LS2-2 NK cell abnormalities and reproductive failures

Atsushi Fukui
Department of Obstetrics and Gynecology, School of Medicine, Hyogo Medical University

12:55 - 14:15

Symposium 3 : Premature Labor/Preeclampsia

Chairs : Takeshi Nagamatsu
Department of Obstetrics and Gynecology, International University of Health and Welfare
Narita Hospital
Katsuhiko Naruse
Department of Obstetrics and Gynecology, Dokkyo Medical University

S3-1 The regulatory mechanism of extravillous trophoblast invasion through microRNAs

Hironori Takahashi
Department of Obstetrics and Gynecology Jichi Medical University

S3-2 Cervical remodeling in preterm labor

Jinying Yang
Department of Obstetrics, Longgang District Maternal & Child Healthcare Hospital of Shenzhen City

S3-3 Immune Regulation and Lymphatic Vessel Development in Severe Preeclampsia

Yong-Sun Maeng
Department of Obstetrics and Gynecology, Institute of Women's Life Medical Science, Yonsei University College of Medicine

14:15 - 14:30

Coffee Break: Outside Room 1 (301)

14:30 - 15:10

Special Lecture 5

Chair : Toshiyuki Takeshita
Takeshita Ladies Clinic

SL5 Delivery of prostate cancer-associated non-coding RNAs within the bone marrow milieu

Toshihiro Takizawa
Department of Molecular Medicine and Anatomy, Nippon Medical School

15:10 - 16:10

Special Lecture 6

Chair : Hiroaki Shibahara

Department of Obstetrics and Gynecology, School of Medicine, Hyogo Medical University

SL6

Endometrial gene expression and reproductive failures

Joanne Y.H. Kwak-Kim [Video]

Reproductive Medicine and Immunology, Chicago Medical School, Rosalind Franklin University of Medicine and Science

16:10 - 16:15

Closing Remarks

8:30 - 9:06

Outstanding Award 1

Chair : Mayumi Sugiura

Department of Obstetrics and Gynecology, Nagoya City University Graduate School of Medicine

OA1-1

Withdrawn

OA1-2

Uterine endometrium microbiota and pregnancy outcome in women with recurrent pregnancy loss

Yutoku Shi

Department of Obstetrics and Gynecology, Kobe University Graduate School of Medicine

OA1-3

High 25-hydroxycholesterol induces apoptotic and ferroptotic cell death by causing oxidative stress in trophoblast cells

Ki Mo Lee

Department of Obstetrics and Gynecology, College of Medicine, Konyang University Myunggok Medical Research Institute

OA1-4

Alternative pathway specific complement regulator C1q/TNF-related protein 6 is related the placental development and fetal growth

Ai Takeshita

Department of Anatomy and Neurobiology, Faculty of Medicine, Kindai University

9:06 - 9:54

Outstanding Award 2

Chair : Hidetaka Okada

Department of Obstetrics and Gynecology, Kansai Medical University

OA2-1

The effects of neonatal corticosterone administration on Sertoli cell number in the testes of mice in prepubertal and postpubertal stages

Hidenobu Miyaso

Department of Anatomy, Faculty of Medicine, School of Medicine, International University of Health and Welfare

OA2-2

SCM-198 prevents endometriosis by reversing low autophagy of endometrial stromal cell via balancing ER α and PR signals

Yikong Lin

Gynecology and Obstetrics Hospital, Fudan University

OA2-3

Characterization of a spontaneously-occurring self-reactive antibody against sperm in mice

Yuekun Chen

Department of Obstetrics and Gynecology, School of Medicine, Hyogo Medical University

OA2-4

TULP2 deletion mice exhibit abnormal sperm flagellar structure and male infertility

Yuki Oyama

Department of Experimental Genome Research, Osaka University

9:56 - 10:11

Award Ceremony

10:13 - 11:13

Oral 6 : Endometriosis and Gynecological Cancer

Chair : Kei Kawana

Department of Medicine, Nihon University

O6-1 **Inappropriate inflammation in ovarian endometrial cysts correlates with excessive T-cell activation and increased level of high-mobility group box-1**

Mariko Ikeda

Department of Obstetrics and Gynecology, Nippon Medical School

O6-2 **Endometriotic cell-derived adenosine triphosphate (ATP) promotes the fibrosis of endometriotic lesions via eosinophil activation**

Yosuke Ono

Department of Obstetrics and Gynecology, University of Yamanashi

O6-3 **The role of p62, an autophagy-related protein, as a marker of radiosensitivity in cervical cancer**

Mihoko Yoshida

Department of Obstetrics and Gynecology, Toyama University, Toyama, Japan

O6-4 **Cytosolic estrogen receptor alpha regulates cell cycle and mitochondrial membrane potential of endometrial carcinoma cells**

Zhong-Lian Li

Department of Anatomy, Tokyo Medical University

O6-5 **Novel use of immune checkpoint inhibitors for vaginal melanoma: A retrospective study**

Kota Konishi

Department of Obstetrics and Gynecology, Faculty of Medicine, Oita University

11:13 - 11:37

Oral 7 : COVID-19

Chair : Hiroyuki Tanaka

Department of Obstetrics and Gynecology, School of Medicine, Hyogo Medical University

O7-1 **Evaluation of protein expression and phosphorylation of SARS-CoV-2-infected placental tissue in the second trimester by tandem mass tag system**

Kazuhide Takada

Division of Microbiology, Department of Pathology and Microbiology, Nihon University School of Medicine

O7-2 **SARS-CoV-2 infection in pregnant female mouse featured as delayed anti-viral response**

Lu Liu

Laboratory for Reproductive Immunology, NHC Key Lab of Reproduction Regulation (Shanghai Institute of Planned Parenthood Research), Shanghai Key Laboratory of Female Reproductive Endocrine-Related Diseases, Hospital of Obstetrics and Gynecology, Shanghai Medical College, Fudan University

13:00 - 13:48

Oral 8 : Sperm, Testis and Male Infertility-1

Chair : Akiko Hasegawa

Department of Obstetrics and Gynecology, School of Medicine, Hyogo Medical University

O8-1

Role of Calpain in Human Sperm for Fertilization

Yasuhiko Ozaki

Department of Obstetrics and Gynecology, Nagoya City University West Medical Center

O8-2

Detection of Sperm Antigens Corresponding to Sperm-Immobilizing Antibodies in Infertile Women

Haruka Honda

Department of Obstetrics and Gynecology, School of Medicine, Hyogo Medical University

O8-3

Study of abnormal spermatogenesis in mouse model of Down syndrome

Tomohiko Wakayama

Department of Histology, Graduate School of Medical Sciences, Kumamoto University

O8-4

Co-administration of the traditional medicines Hachimi-jio-gan and Hochu-ekki-to can reverse busulfan-induced aspermatogenesis

Ning Qu

Tokai University School of Medicine, Tokyo Medical University

13:48 - 14:24

Oral 9 : Sperm, Testis and Male Infertility-2

Chair : Masakatsu Fujinoki

Research Center for Laboratory Animals, Dokkyo Medical University

O9-1

ADAD2 functions in spermiogenesis and piRNA biogenesis in mice

Yonggang Lu

Immunology Frontier Research Center, Osaka University

O9-2

ERP2 is required for sperm motility and male fertility in male mice

Hsin-Yi Chang

Department of Experimental Genome Research, Research Institute for Microbial Diseases, Osaka University

O9-3

GARIN2 is not essential for male fertility in mice

Haoting Wang

Graduate School of Pharmaceutical Sciences, Osaka University

14:24 - 15:00

Oral 10 : Preterm Birth

Chair : Koichiro Shimoya

Department of Obstetrics and Gynecology, Kawasaki Medical School

O10-1

Role of immune cells in preterm birth induced by sterile inflammation

Yasuyuki Negishi

Department of Microbiology and Gynecology, Nippon Medical School

O10-2 Prophylactic treatment with progesterone prevents murine miscarriage by suppressing the immunostimulatory activity of macrophage

Asane Iida

Department of Microbiology and Immunology, Nippon Medical School

O10-3 Novel etiological analysis of preterm births related to innate immunity and sterile inflammation

Masahiko Kato

Department of Obstetrics and Gynecology, Nippon Medical School

Sponsors

List of Sponsors

*In alphabetical order, as of April 5

Aiken Co., Ltd

BAYS' Co., Ltd.

Ferring Pharmaceuticals Co., Ltd.

Fuchu Nozomi Clinic

Fuji Pharma Co., Ltd.

GE Healthcare Japan Corporation

Gun-yu Kai (Alumni Association of Department of Obstetrics and Gynecology, School of Medicine, Hyogo Medical University)

Hanabusa Women's Clinic

Hiroshima HART Clinic

HORAC GRAND FRONT OSAKA Clinic

Japan Clinical Embryologist Association

Japan Society for Immunology of Reproduction

Japan Society of Assisted Reproduction

Johnson&Johnson ETHICON

Keiai Ladies Clinic

Koba Ladies' Clinic

Kobe Convention Bureau

Medical Corporation SANTA CRUZ

Nanosonics Japan K. K.

Ritz Medical Co., Ltd.

ROHTO Pharmaceutical Co., Ltd.

Setouchi Society for Assisted Reproductive Technology

SUGI Women's Clinic

Tsubaki Women's Clinic

Tsutomu Nakauchi Foundation

YAYOI Corporation

Zeria Pharmaceutical Co., Ltd.

培養室の人材足りてますか？

- 症例数が増えた
- 教育まで手が回らなく培養士が育たない
- ICSIできる人がいない
- 新規オープンしたいが胚培養士が見つからない

そんなときは…

BAYSにお任せください！

ベース
BAYS株式会社

〒231-0033 神奈川県横浜市中区長者町4-11-7
TEL: 045-341-0128 / FAX: 045-341-0129
【拠点】 札幌 横浜 大阪 福岡

全国どこでも伺います！
まずはお問い合わせください

<https://www.bays-y.com/>
Mail: q@bays-y.com

ベース株式会社
派14-303220
14-ユ-301764



ART業界初の協会が設立しました

私たちが協会を設立した主な理由

1. 胚培養士の認知度・地位向上への一助
2. 胚培養士を目指す学生の教育環境整備
3. 不妊等生殖医療に関する啓蒙活動

現在 学校・法人・施設単位での会員、及び広告会員、個人会員を募集中です。
当協会活動について ぜひ一度ホームページをご覧ください。

<https://jcea.ne.jp>



一般社団法人 日本臨床胚培養士協会

〒231-0033 神奈川県横浜市中区長者町4-11-7 《TEL》 045-309-8144 《FAX》 045-309-8101

“からだ”の声に
耳を傾ける

ゼリア新薬工業株式会社は、
11月26日を鉄分の日と制定し、
鉄分不足の啓発に取り組んでいます。

TAKEIRONSERIOUSLY

 **ゼリア新薬工業株式会社**
ZERIA

私たちにしかできないことがあります。

広島HARTクリニック 

お気軽にお問い合わせ下さい。

082-567-3866

診療時間内にお電話ください。

日・祝日休診

	月	火	水	木	金	土	日・祝日
9:00~12:00	●	●	●	●	●	●	—
14:30~17:00	●	●	●	—	▲	—	—

▲15:00~17:00

〒732-0822 広島市南区松原町3-1 301 E-mail info@hiroshima-hart.jp <http://www.hiroshima-hart.jp>



Ladies Clinic SANTA CRUZ

レディースクリニック サンタクルス

～不妊治療から妊娠・出産・子育てまで～

高度不妊治療施設

レディース & ARTクリニック サンタクルス ザ ニシキタ
阪急西宮北口駅 徒歩1分 0798-62-1188



the NISHIKITA

レディース & ARTクリニック サンタクルス ザ ウメダ
阪急大阪梅田駅 NU 茶屋町プラス 3階 06-6374-1188 [NIPT 認定施設]



the UMEDA

分娩施設

レディース & マタニティクリニック サンタクルス ザ シュクガワ
阪急夙川駅 徒歩3分 0798-75-1188 [NIPT 認定施設]



the SHUKUGAWA

レディース & マタニティクリニック サンタクルス ザ タカラヅカ
阪急宝塚南口駅 徒歩10分 0797-83-1188



the TAKARAZUKA

婦人科

レディースクリニック サンタクルス ザ シンサイバシ
御堂筋線心斎橋駅直結 心斎橋パルコ10階 06-6253-1188



the SHINSAIBASHI

小児科

チャイルド & レディースクリニック サンタクルス ザ シュクガワ
阪急夙川駅 徒歩3分 0798-75-1052

ご用命を心よりお待ち申し上げます



遺伝子組換えヒト卵胞刺激ホルモン (FSH) 製剤 薬価基準収載

レコベル® 皮下注

12 μ g/36 μ g/72 μ g ペン

Rekovel® ホリトロピン デルタ 生物由来製品・処方箋医薬品^注
(遺伝子組換え) 注) 注意—医師等の処方箋により使用すること

本剤の効能又は効果、用法及び用量、警告・禁忌を含む注意事項等
情報等については、電子化された添付文書をご参照ください。

製造販売元(輸入)

FERRING
PHARMACEUTICALS

フェリング・ファーマ株式会社

〒105-0001 東京都港区虎ノ門二丁目3番17号
文献請求先および問い合わせ先 ぐすり相談室
フリーダイヤル: 0120-093-168 FAX: 03-3596-1107

レコベル®、Rekovel®はフェリング・ファーマB.V.の登録商標です
© 2022 Ferring Pharmaceuticals Co., Ltd.

F/348PA/02/22/J
2022年4月作成(第3版)

停電に不安を感じている病院・医院様へ

非常用バックアップ電源

安心-あんしん-

オンサイト保守あり

製品5年保証

停電時には自動切替で電気供給



納得!

停電の不安がこれ1台で安心へ! 貴院に最適な機器選びをご提案いたします。

アイケンは200件以上の不妊治療をされる医院様へ納品実績があります。「どれを何時間バックアップすればいいの?」「製品の違いや種類が分からない」など、あらゆるお客様の疑問にお答えします。

停電時

工事不要!



停電を感知すると蓄電池から電気を自動切替で供給

接続するだけ

給電

系統電源

屋内

接続機器

福井ウイメンズクリニック様



培養室

城山公園すずきクリニック様



インキュベーター ×4台

300W

合計消費電力 1200W

OA-2000B6
24時間以上
使用可能

不妊治療外来クリニック様でのインキュベーターや、培養室における作業時の電源確保手段として。また、検体や薬品の保管に必要な保冷庫やフリーザーへも対応可能です。

【実際に測定しました!】インキュベーターは、庫内の温度が安定した後は、消費電力が非常に小さいといった特性がある為、長時間のバックアップが可能となります。

実績が
違う!

全国のクリニックさまから選ばれています。

弊社ホームページでも多数ご紹介しています。

いわき婦人科様(福島県)

おち夢クリニック名古屋様(愛知県)

ゆげレディースクリニック様(宮崎県)

千葉レディースクリニック(千葉県)

リブダクションクリニック大阪様(大阪府)

培養室

培養室

培養室

待合室 バックヤード

培養室



非常用バックアップ電源
安心-あんしん-

動画紹介はこちら お手持ちのスマートフォンでQRコードを撮影して下さい。



いますぐ
簡単アクセス!



株式会社アイケン アイケン 蓄電池

〒581-0013 大阪府八尾市山本町南7丁目13-27 <http://www.aikenet.com> ☎ info@aikenet.com

TEL 072-943-1001



約半世紀、 女性たちの笑顔のために。

近年、働く女性が増えている一方で、月経や妊娠・出産など、女性特有の健康課題に悩まされる方も少なくありません。そんな女性の健康リスクを、医薬の力で支えたい。私たち富士製薬工業は、そう願っています。1965年の会社設立以降、女性医療分野に特化し、ライフステージに寄りそった医薬品を開発・製造・販売。また、スマートフォンアプリの提供をはじめ、女性の健康支援を目的とした啓発活動も行っています。私たちはこれからも、働く女性のすこやかな毎日のために、女性のこころとからだをトータルにサポートしてまいります。



富士製薬工業株式会社

本社 東京都千代田区三番町5番地7
海外拠点 OLIC(Thailand) Limited
<https://www.fujipharma.jp/>



医療法人社団 真緑会

Koba

レディースクリニック

院長 医学博士

小林真一郎

副院長 医学博士

加藤 徹

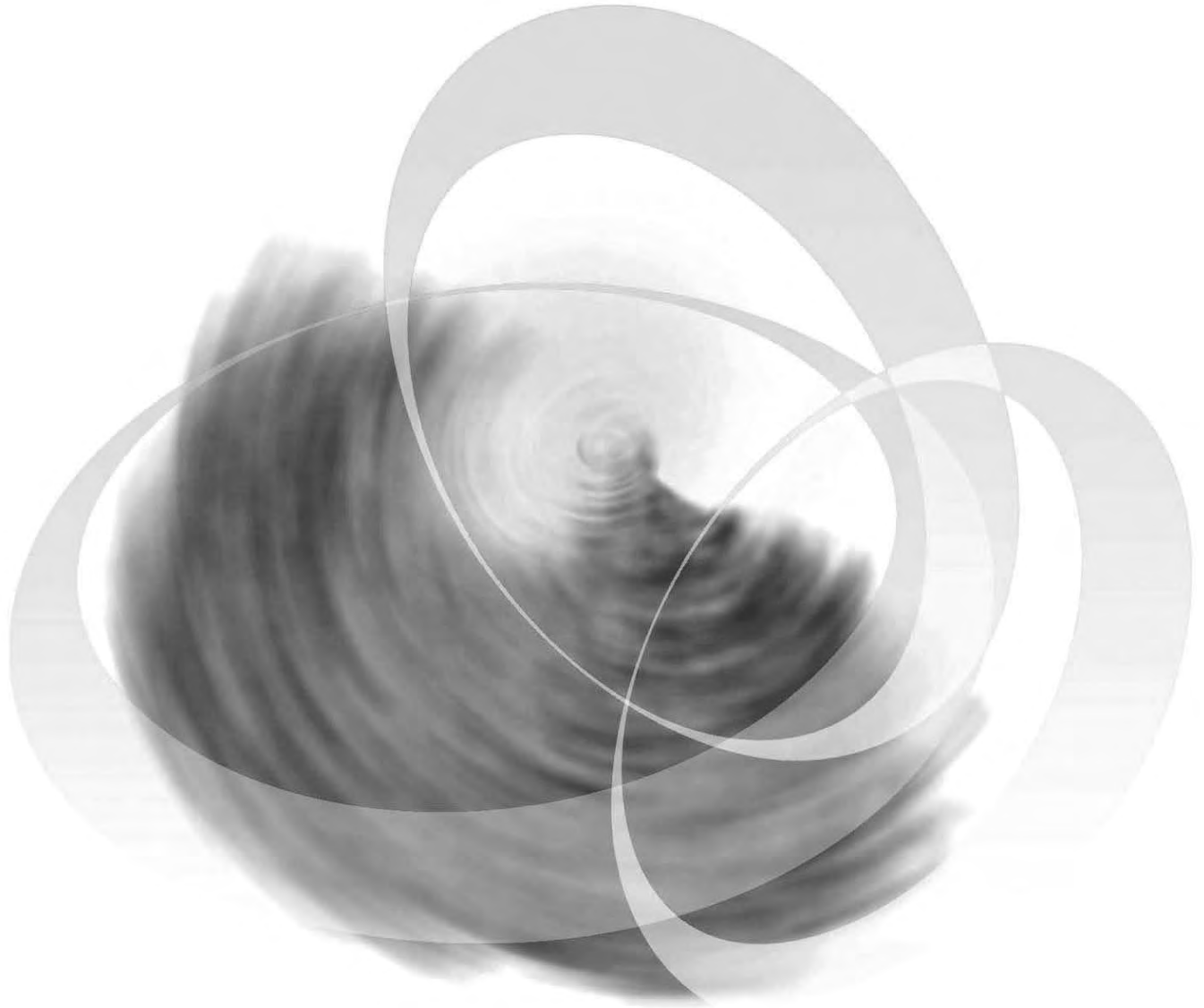

*体外受精・顕微授精の治療を細心の注意のもと、安心・安全・確実にこなします。

〒670-0935

兵庫県姫路市北条口2丁目18 宮本ビル1F

Tel : 079-223-4924 Fax : 079-223-4925

<https://www.koba-ladies.jp/>

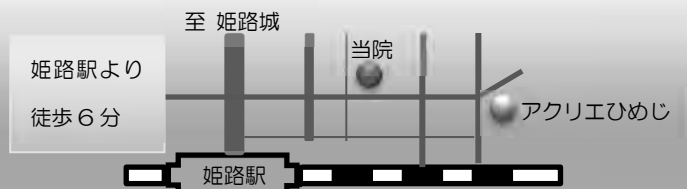

すべての患者様が子宝に恵まれますよう

IVF JAPANグループは、最先端の不妊治療技術と統合医療を組み合わせ、すべての患者様の希望となれるよう挑んでまいります。

HORACグランフロント大阪クリニック

大阪市北区大深町3-1 グランフロント大阪 タワーB 15F
TEL: 06-6377-8824

院長 森本 義晴



IVF大阪クリニック

東大阪市長田東
1-1-14
TEL:
06-4308-8824

院長
福田 愛作



IVFなんばクリニック

大阪市西区
南堀江1-17-28
TEL:
06-6534-8824

院長
中岡 義晴



 IVF JAPAN GROUP

ISIVF2023

21st World Congress on In Vitro Fertilization

Theme

Où allons-nous?

Yoshiharu Morimoto
(President, ISIVF)

Joint Conference

26th
Annual Scientific Meeting of
Japan Society of Assisted Reproduction
(26th JSAR)

Theme

Approach to sustainable ART

Yoshiharu Nakaoka
(IVF Namba Clinic)

Date

2(Thu)~4(Sat) November, 2023

Venue

Osaka International Convention Center
Osaka, JAPAN



[Secretariat]

JTB Communication Design, Inc.

Co-Creation Dept. Convention Unit 2
Celestine Shiba Mitsui Bldg. 12F 3-23-1 Shiba, Minato-ku, Tokyo, Japan 105-8335
E-mail: isivf-jsar2023@jtbcom.co.jp

[Website]

<https://convention.jtbcom.co.jp/isivf-jsar2023>

ISIVF 2023
International Society for In Vitro fertilization

JSAR

ロート製薬の経験をお試しく下さい。

R:STEM

One step beyond with

A:O:F

- 2013年 再生医療に本格進出
- 2016年 ロート幹細胞加工センター(京都府)にて特定細胞加工物製造許可を取得
- 2017年 自動培養装置を開発
- 2017年 肝硬変患者を対象として細胞製剤で第I/II相試験を開始
- 2018年 肝硬変患者を対象とした細胞製剤の日本国内の独占的な開発および販売に関するライセンス契約締結
- 2019年 ロート幹細胞加工センター東京(東京都)にて特定細胞加工物製造許可を取得
- 2020年 COVID-19重症肺炎を対象として細胞製剤で第I相試験を開始
- 2021年 オリンパスRMS(株)(現:インターステム(株))の全株式を取得し、整形外科領域を強化
- 2021年 COVID-19重症肺炎を対象として細胞製剤で第II相試験を開始
- 2022年 再生医療等関連製品の開発・受託製造(CMO/CDMO)サービス開始

培地販売

- 間葉系幹細胞用培地
- 生物由来基準適合
- 無血清培地
- 動物・ヒト由来原料不含



細胞加工・受託サービス

- 治療用細胞製造
- GCTPに準拠可
- 医療機関向け
- 製薬メーカー向け



共同開発・技術導出

- 再生医療等製品の開発と製造

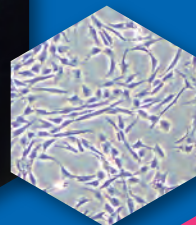

自動培養装置の販売

- 安定した製造能力
- 培養士負担軽減
- 各種プロトコールに対応

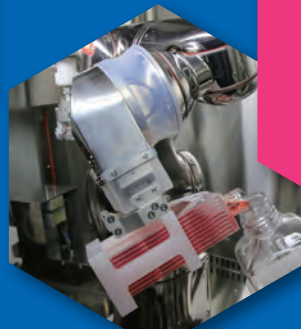

お気軽にお問合せください。

E-mail: rstem_info@rohto.co.jp



Auberge Clinic





Assisted Reproductive Technology

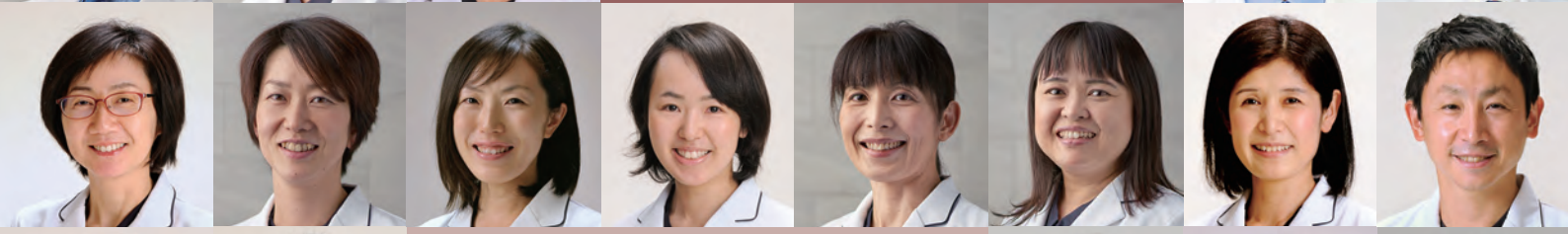

Painless Delivery

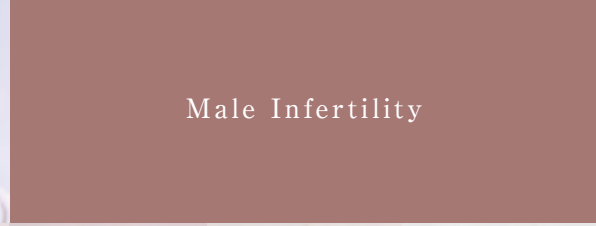
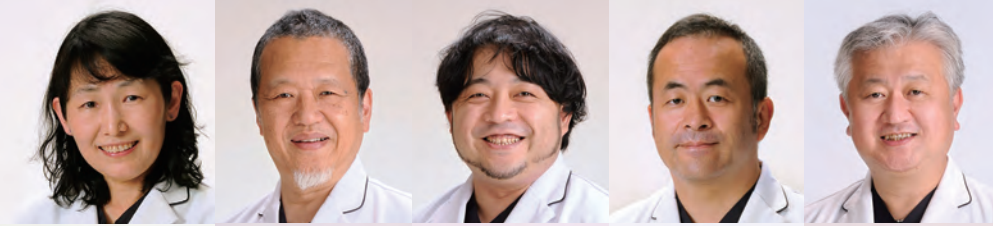

Male Infertility



Women's Healthcare



